

INSECTRON®

CE MARK • ISO 9001 • ATEX • IP54/IP65 • 5 ANS GARANTIE

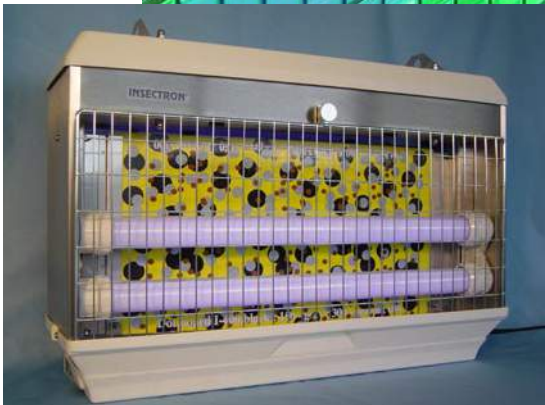
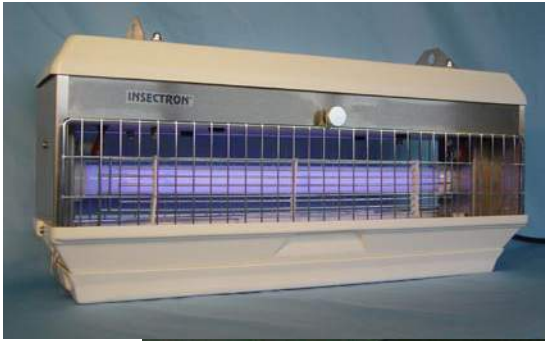

technimat

Contrôle des insectes volants





IN100CE



IN100CG



IN100WE



IN100WG

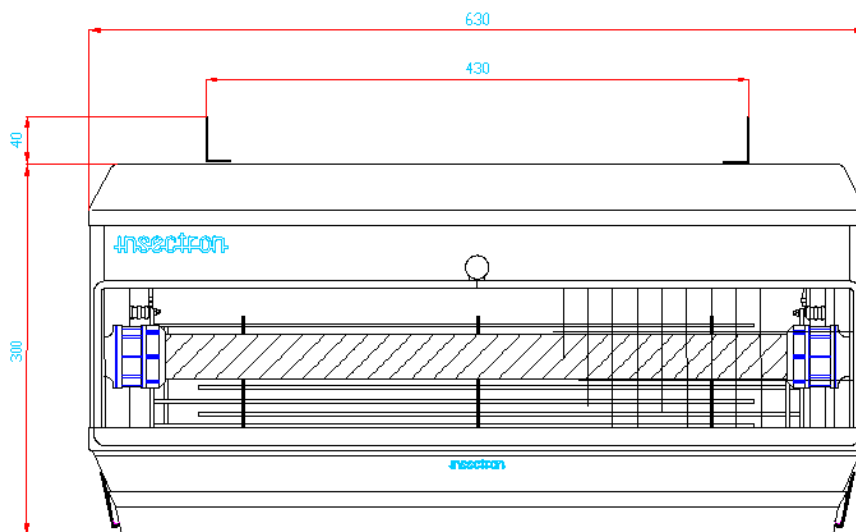
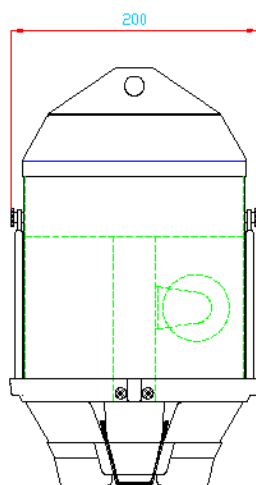

Type	IN100 CE	IN100CG	IN100WE	IN100WG
L x h x P	63 x 47,5 x 20 cm	63 x 47,5 x 20 cm	63 x 47,5 x 20 cm	63 x 47,5 x 20 cm
Poids	10 kg	10 kg	10 kg	10 kg
Alimentation électrique	230V/240V (50Hz)	230V/240V (50Hz)	230V/240V (50Hz)	230V/240V (50Hz)
Surface couverte	100m ²	100m ²	100m ²	100m ²
UV-A lampes	1x 18W	1x 18W	1x 18W	1x 18W
Lampes vertes	Option	Option	Option	Option
Consommation électrique	45W maximum	35W maximum	45W maximum	35W maximum
Montage mural	Non	Non	Oui	Oui
Protection classe	IP54	IP54	IP54	IP54
Convient aux environnements humides, poussiéreux ou explosif	Non	Non	Non	Non



IN200CE

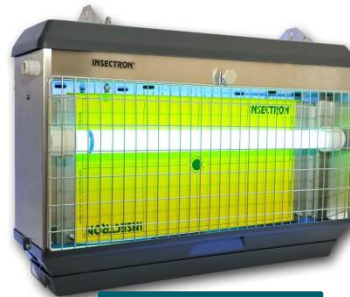

IN200CG



IN200WE



IN200WG

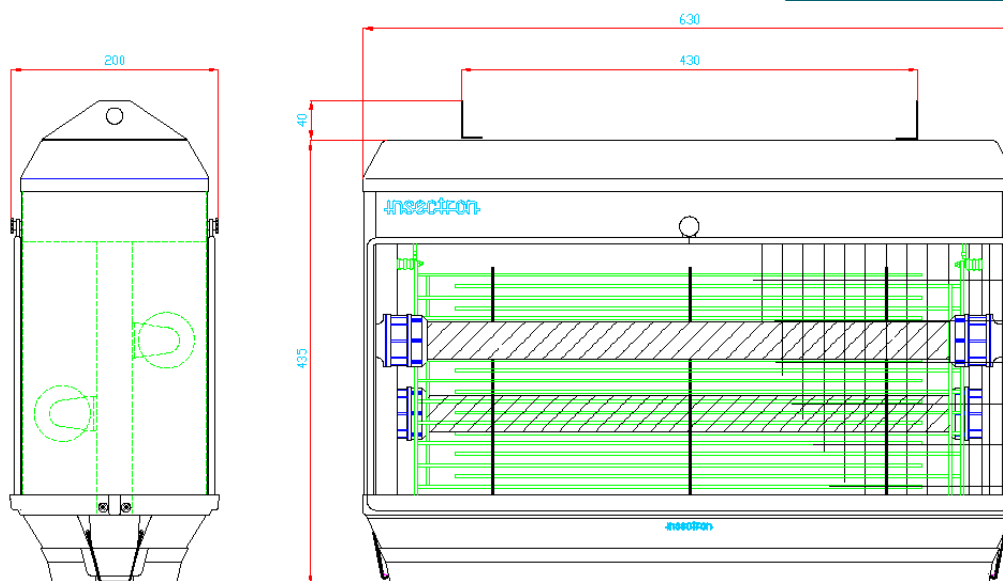

Type	IN200 CE	IN200CG	IN200WE	IN200WG
L x h x P	63 x 55 x 20 cm	63 x 55 x 20 cm	63 x 55 x 20 cm	63 x 55 x 20 cm
Poids	13 kg	13 kg	13 kg	13 kg
Alimentation électrique	230V/240V (50Hz)	230V/240V (50Hz)	230V/240V (50Hz)	230V/240V (50Hz)
Surface couverte	200m ²	200m ²	200m ²	200m ²
UV-A lampes	2x 18W ou 2x 20W	2x 18W ou 2x 20W	2x 18W ou 2x 20W	2x 18W ou 2x 20W
Lampes vertes	Option	Option	Option	Option
Consommation électrique	95W maximum	85W maximum	95W maximum	85W maximum
Montage mural	Non	Non	Oui	Oui
Protection classe	IP54	IP54	IP54	IP54
Convient aux environnements humides, poussiéreux ou explosif	Non	Non	Non	Non



IN300CE

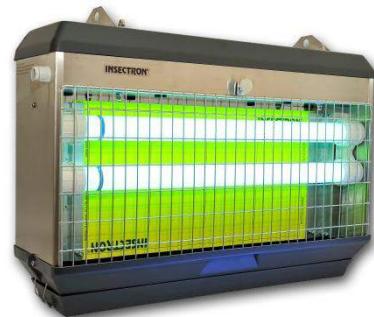

IN300CG

Pour montage
au plafond



IN300WE



IN300WG

Pour montage mural

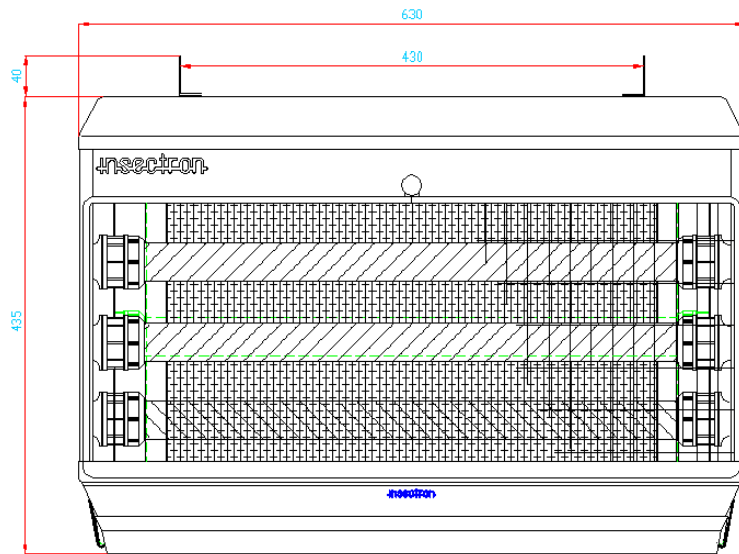
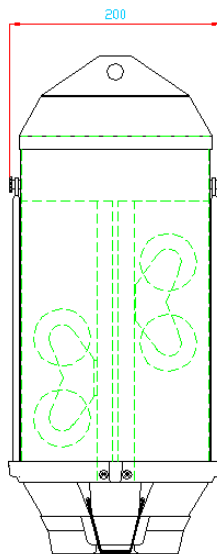

Type	IN300 CE	IN300CG	IN300WE	IN300WG
L x h x P	63 x 55 x 20 cm	63 x 55 x 20 cm	63 x 55 x 20 cm	63 x 55 x 20 cm
Poids	14 kg	14 kg	14 kg	14 kg
Alimentation électrique	230V/240V (50Hz)	230V/240V (50Hz)	230V/240V (50Hz)	230V/240V (50Hz)
Surface couverte	400m ²	400m ²	300m ²	300m ²
UV-A lampes	4x 18W ou 4x 20W	4x 18W ou 4x 20W	3x 18W ou 3x 20W	3x 18W ou 3x 20W
Lampes vertes	Option	Option	Option	Option
Consommation électrique	180W maximum	170W maximum	120W maximum	110W maximum
Montage mural	Non	Non	Oui	Oui
Protection classe	IP54	IP54	IP54	IP54
Convient aux environnements humides, poussiéreux ou explosif	Non	Non	Non	Non



IN400CE

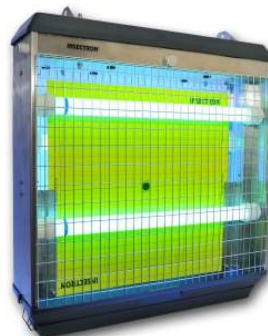

IN400CG

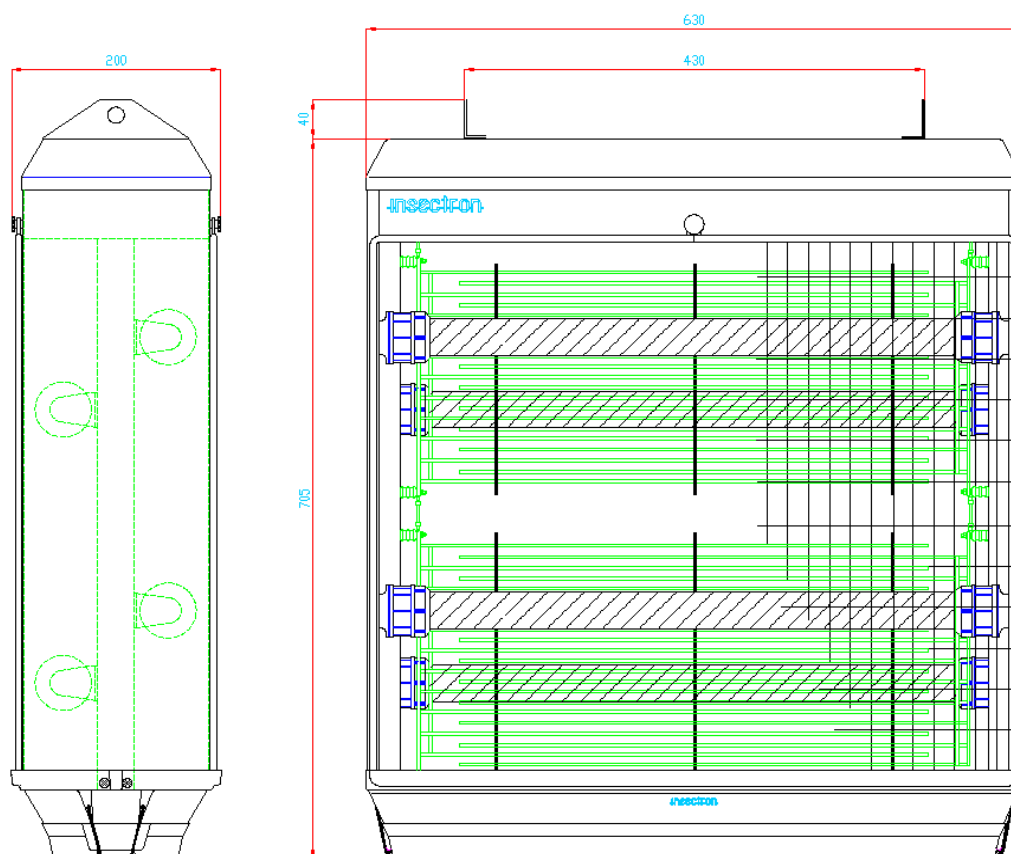

Type	IN400 CE	IN400CG
L x h x P	63 x 85 x 20 cm	63 x 85 x 20 cm
Poids	19 kg	19 kg
Alimentation électrique	230V/240V (50Hz)	230V/240V (50Hz)
Surface couverte	400m ²	400m ²
UV-A lampes	4x 18W ou 4x 20W	4x 18W ou 4x 20W
Lampes vertes	Option	Option
Consommation électrique	180W maximum	170W maximum
Montage mural	Non	Non
Protection classe	IP54	IP54
Convient aux environnements humides, poussiéreux ou explosif	Non	Non

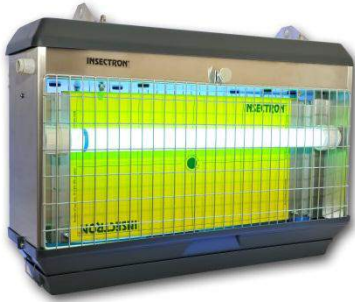

IN200ATEX



IN300ATEX

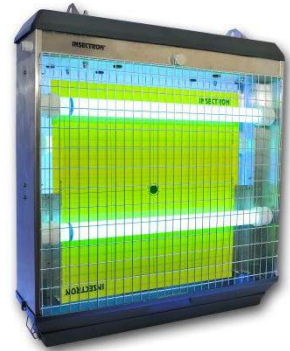

IN400ATEX

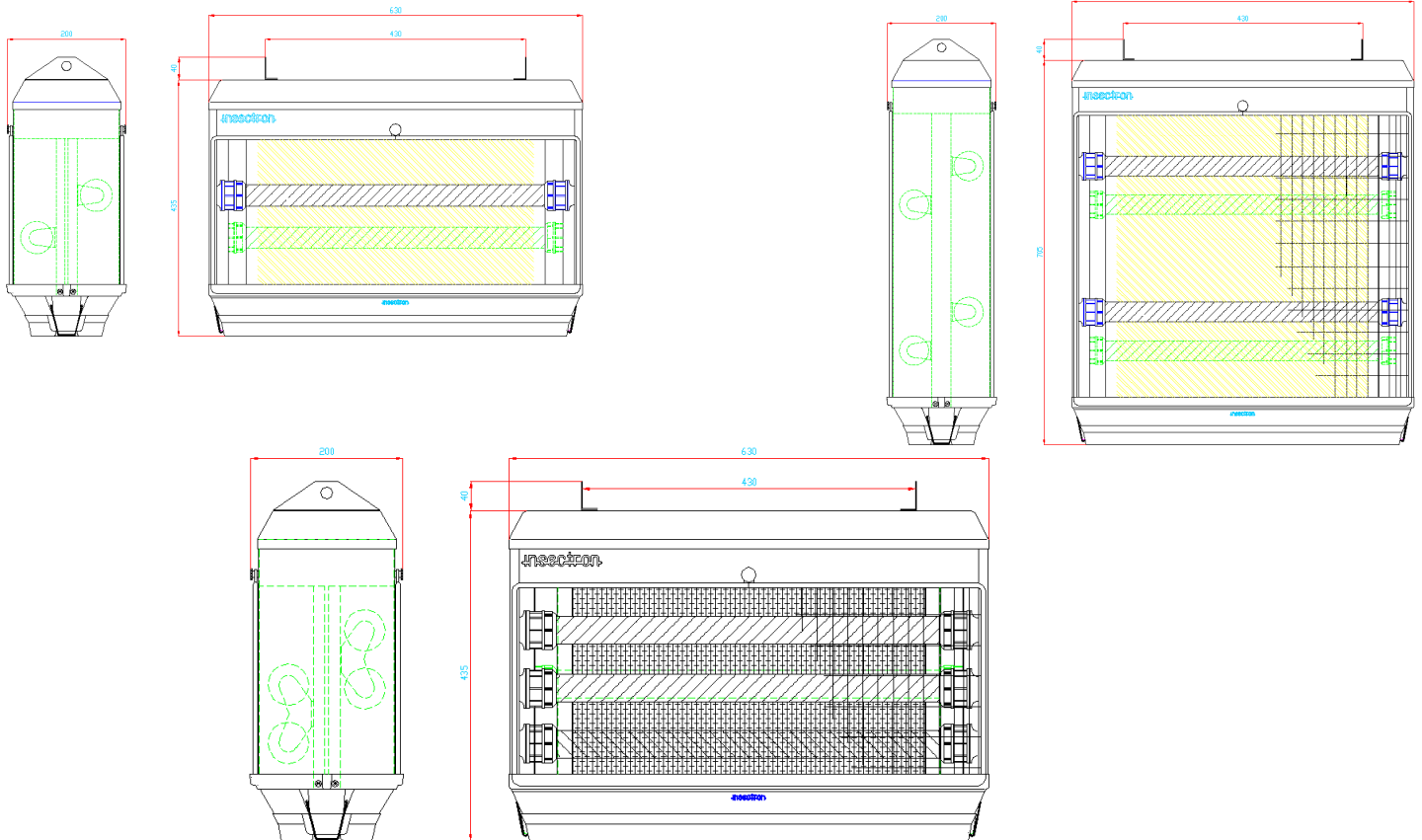

Type	IN200ATEX	IN300ATEX	IN400ATEX
L x h x P	63 x 55 x 20 cm	63 x 55 x 20 cm	63 x 85 x 20 cm
Poids	13 kg	14 kg	19 kg
Alimentation électrique	230V/240V (50Hz)	230V/240V (50Hz)	230V/240V (50Hz)
Surface couverte	200m ²	400m ²	400m ²
UV-A lampes	2x 18W ou 2x 20W	4x 18W ou 4x 20W	4x 18W ou 4x 20W
Lampes vertes	Option	Option	Option
Consommation électrique	85W maximum	170W maximum	170W maximum
Montage mural	Non	Non	Non
Protection classe	IP65	IP65	IP65
Convient aux environnements humides, poussiéreux ou explosif	Oui	Oui	Oui

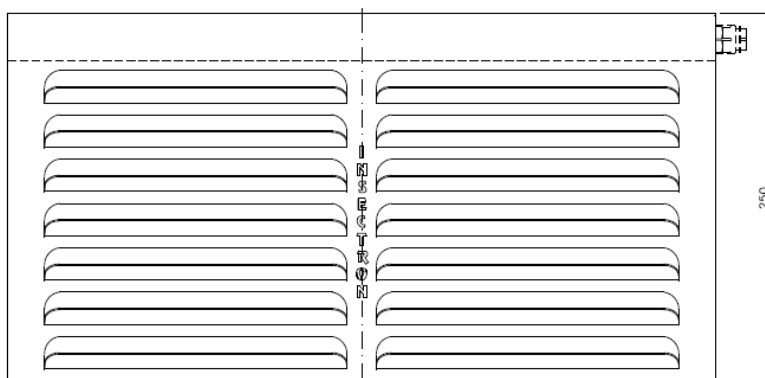
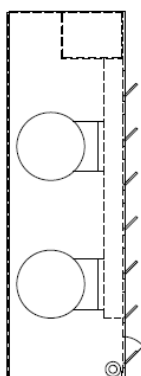
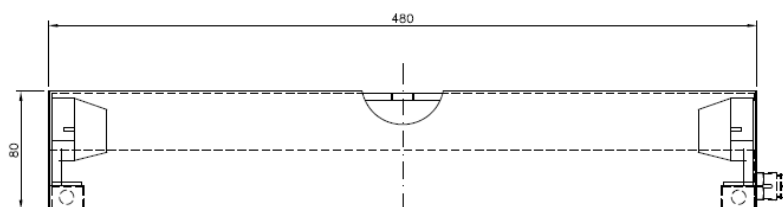
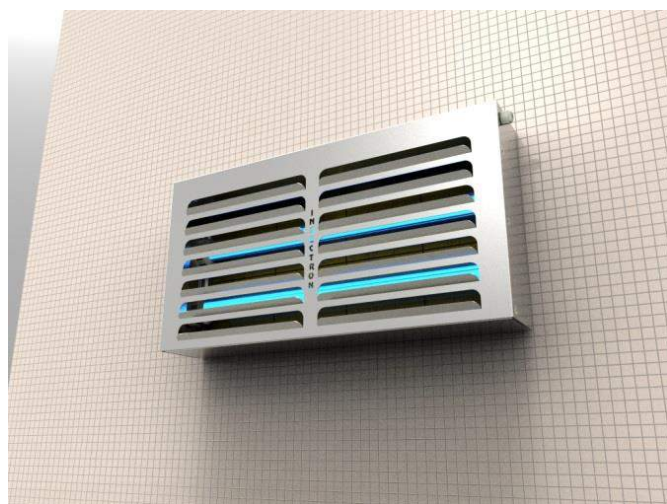
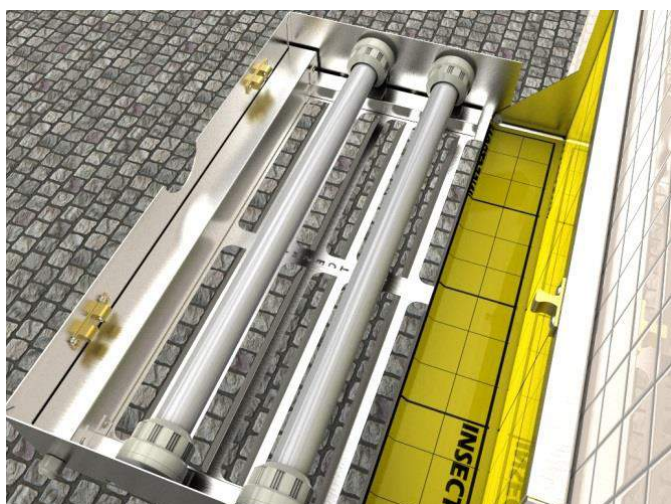

Type	Insectron T2	Service space		
L x h x P	25 x 48 x 8 cm	26 x 55 x 35 cm		
Poids	3 kg			
Alimentation électrique	230V/240V (50Hz)			
Surface couverte	100m ² max			
UV-A lampes	2x 15W			
Lampes vertes	Option			
Consommation électrique	35W maximum			
Montage mural	Oui			
Protection classe	IP52			
Convient aux environnements humides, poussiéreux ou explosif	Non			